

NC STATE UNIVERSITY College of Education

COMMENCEMENT CEREMONY



May 5, 2023

Educational Leadership, Policy, and Human Development
Science, Technology, Engineering, and Mathematics Education
Teacher Education and Learning Sciences



Order of Exercises

Processional

Welcome

Dr. Paola Sztajn

Dean

Introduction of Student Speaker

Dr. Karen Hollebrands

Associate Dean

Charge to the Graduate Students

Abraham Luis Dones

Adult and Community College Education

Presentation of Doctoral Degrees

Dr. Karen Hollebrands

Educational Leadership, Policy, and Human Development

Dr. Marc A. Grimmert

Interim Department Head

Science, Technology, Engineering, and Mathematics Education

Dr. Aaron C. Clark

Department Head

Teacher Education and Learning Sciences

Dr. Kevin M. Oliver

Department Head

Presentation of Outstanding Doctoral Dissertation Awards

Dr. Karen Hollebrands

Presentation of Master's Degrees

Dr. John K. Lee

Associate Dean

Educational Leadership, Policy, and Human Development

Dr. Marc A. Grimmert

Science, Technology, Engineering, and Mathematics Education

Dr. Aaron C. Clark

Teacher Education and Learning Sciences

Dr. Kevin M. Oliver

Introduction of Student Speaker

Dr. Anona Smith Williams

Associate Dean

Charge to the Undergraduate Students

Kailee Jaye Storie

Elementary Education

Presentation of Undergraduate Degrees

Dr. John K. Lee

Science, Technology, Engineering, and Mathematics Education

Dr. Aaron C. Clark

Teacher Education and Learning Sciences

Dr. Kevin M. Oliver

Special Recognitions

Dr. Anona Smith Williams

Closing Remarks

Dr. Paola Sztajn

DOCTOR OF EDUCATION

Gabrielle McCutchen

Adult and Community College Education

Dissertation: *Faculty Perceptions of Their Role and Their Institution's Role in Closing Equity Gaps*, under the direction of Professor Chad Hoggan.

Abraham Luis Dones

Adult and Community College Education

Dissertation: *Understanding the Enrollment and Persistence Experiences of First Time in College Latinx Students at a Community College in the South Region of the United States*, under the direction of Professors Audrey Jaeger and Carrol Warren.

Alma Rodriguez Jones

Community College Leadership

Dissertation: *Exploring Mental Health Literacy Among Faculty at a Rural Community College After the COVID Pandemic*, under the direction of Professor Carrol Warren.

Amy J. Mahle

Community College Leadership

Dissertation: *Exploring Community College Presidents' Communication with Employees During a Global Pandemic*, under the direction of Professor Carrol Warren.

Britney Le Anne Shawley

Community College Leadership

Dissertation: *Building a Culture of Support: A Narrative Inquiry Study of the Lived Experiences of Employer Support of North Carolina Community College Employees Enrolled in Graduate Coursework*, under the direction of Professor Carrol Warren.

Russell Lee Parker

Community College Leadership

Dissertation: *Key Partnership Roles in High-Quality Youth Pre-Apprenticeship Programs*, under the direction of Professors James Bartlett and Michelle Bartlett.

Jennifer LaDue

Community College Leadership

Dissertation: *The Lived Experiences of North Carolina Female Community College Presidents Around Mentoring and Being Mentored*, under the direction of Professor Michelle Bartlett.

Lisa Watson Bowen

Educational Administration and Supervision

Dissertation: *Bullying of Middle School Students with Autism Spectrum Disorders: A Qualitative Exploration of Prevalence and Perceptions of Students, Parents, and Teachers*, under the direction of Professor Michael Ward.

DOCTOR OF PHILOSOPHY

Shawn Christopher Wright-Haertel

Educational Leadership, Policy, and Human Development Counseling and Counselor Education

Dissertation: *The Relationship Between Disclosure and Sexual Orientation of Black Men Who Sleep with Men and Their Attachment Styles*, under the direction of Professor Stanley Baker.

Karimah L'trelle Midgette

Educational Leadership, Policy, and Human Development Counseling and Counselor Education

Dissertation: *Understanding the Protective Factors Employed by African American Women Diagnosed with Female Infertility*, under the direction of Professor Stanley Baker.

Alyssa Nicole Anderson

Educational Leadership, Policy, and Human Development Adult and Lifelong Education

Dissertation: *A Case Study of Nutrition Educators' Perspectives on the Delivery of Virtual Community Nutrition Programming*, under the direction of Professor Susan Barcinas.

Chrystal Louise Coble

Educational Leadership, Policy, and Human Development Adult and Lifelong Education

Dissertation: *A Narrative Inquiry of Queer Graduate Student Experiences with Classroom Climate*, under the direction of Professor Michelle Bartlett.

Jeremy Allen Gilmore

Educational Leadership, Policy, and Human Development Adult and Lifelong Education

Dissertation: *Blessings and Cursings: A Phenomenological Study on the Usage of Profanity in Clinical Pastoral Education*, under the direction of Professor Jayne Fleener.

Elizabeth Ashlyn Locklear[^]

Educational Leadership, Policy, and Human Development Adult and Lifelong Education

Dissertation: *Educating for Uncertainty: A Qualitative Study on Preparing Future-Ready Physicians through Master Adaptive Learning*, under the direction of Professor Jayne Fleener.

LaTisha Aulette Brown

Educational Leadership, Policy, and Human Development Counseling and Counselor Education

Dissertation: *Exploring Systemic Factors Impacting Stress in Black Parents of Autistic Children*, under the direction of Professors Adria Dunbar and Jamie Pearson.

Bredell Keith Moody

Educational Leadership, Policy, and Human Development Counseling and Counselor Education

Dissertation: *Bearing Witness to Terror and Triumph: A Narrative Inquiry into Black Men's Healing after Police Brutality*, under the direction of Professor Marc A. Grimmett.

Matthew Lengen

Educational Leadership, Policy, and Human Development Higher Education

Dissertation: *Binding Admission at Private Higher Education Institutions and Implications for Tuition Revenue and Discounting*, under the direction of Professors Paul Umbach and Steve Porter.

Gordon Wilson Maples

Educational Leadership, Policy, and Human Development Higher Education Opportunity, Equity, and Justice

Dissertation: *Student Religious Accommodation Policies and Non-Christian College Student Perceptions of Institutional Support: A Mixed Methods Dissertation*, under the direction of Professor Alyssa Rockenbach.

Chelsea Tashea Smith

Educational Leadership, Policy, and Human Development
Higher Education Opportunity, Equity, and Justice

Dissertation: *Refuge from the Storm: A Case Study of Black Womens' Experiences in STEM Peer and Research Co-Curricular Programs at a PWI in the Southeast.*, under the direction of Professor Joy Gaston Gayles.

Jordan Christopher Hale

Educational Research and Policy Analysis
Higher Education Administration

Dissertation: *The Role of the Coach in the Storied Experiences of Black Male College Student Athletes*, under the direction of Professor Joy Gaston Gayles.

Drew Michael Goodson

Educational Research and Policy Analysis
Adult and Community College Education

Dissertation: *Factors Associated with Upward Transfer at a Rural Community College*, under the direction of Professor Duane Akroyd.

SCIENCE, TECHNOLOGY, ENGINEERING,
AND MATHEMATICS EDUCATION

DOCTOR OF PHILOSOPHY**Justin Charles Egresitz[>]**

Learning and Teaching in STEM, Engineering and Technology
Education

Dissertation: *Think and Do: A Phenomenological Investigation into Student Motivation toward Making and Doing*, under the direction of Professor Aaron Clark.

Jerome Zegaigbe Amedu

Learning and Teaching in STEM, Mathematics and Statistics
Education

Dissertation: *Examining Mathematics Teachers' Perceptions of the Effects of Informal Learning on Teacher Knowledge and Practices: An Explanatory, Sequential Mixed-Methods Study*, under the direction of Professors Karen Hollebrands and Ruby L. Ellis.

Latoya Lynn Brewer

Learning and Teaching in STEM, Mathematics and Statistics
Education

Dissertation: *Analyzing Relationships among College Students' Interactions with Instructional Videos and their Mathematics Learning: A Qualitative Multi-Case Study*, under the direction of Professor Karen Hollebrands.

David Jerome Stokes

Learning and Teaching in STEM, Mathematics and Statistics
Education

Dissertation: *Examining Sociocritical and Agency Building Educational Experiences in STEM and their Potential to Change Patterns in STEM Underrepresentation*, under the direction of Professor Hollylynne Lee.

Karen Marie Collier⁼

Learning and Teaching in STEM, Science Education

Dissertation: *Exploring and Measuring Influential Factors for Graduate Student Success*, under the direction of Professor Margaret Blanchard.

Madeline Tate Hinckle

Learning and Teaching in STEM, Science Education

Dissertation: *Integrating Computer Science and Computational Thinking into Middle School Science: Exploring the Impacts of a Computational Thinking Focused Research Practice Partnership*, under the direction of Professor Eric Wiebe.

Mwenda Oluwatoyin Kudumu-Biggs

Learning and Teaching in STEM, Science Education

Dissertation: *The Perceptions and Practices of Informal Science Educators Regarding Culturally Relevant Education in Science Centers*, under the direction of Professors K.C. Busch and Soonhye Park.

Emma Jane Refvem

Learning and Teaching in STEM, Science Education

Dissertation: *Science Instructional Coaches: Content Expertise, Beliefs, Motivation, and Contexts*, under the direction of Professor Gail Jones.

Rebecca Vee Ward

Learning and Teaching in STEM, Science Education

Dissertation: *Communicator and Reader Perspectives of Climate Change Visual Displays*, under the direction of Professor Gail Jones.

TEACHER EDUCATION
AND LEARNING SCIENCES

DOCTOR OF PHILOSOPHY**Lili Wang**

Teacher Education and Learning Sciences

Literacy and English Language Arts Education

Dissertation: *A Mixed-Methods Study on the Technology Use of Chinese EFL Teachers in High School Classrooms*, under the direction of Professor Hiller Spires.

Danielle Robin Scharen⁼

Teacher Education and Learning Sciences

Elementary Education in Mathematics and Science

Dissertation: *Examining Elementary Pre-service Teachers' Use of the Touch-Talk-Text Science Instructional Model: An Exploratory Case Study Analysis*, under the direction of Professor Sarah Carrier.

Cigdem Meral

Teacher Education and Learning Sciences

Learning Design and Technology

Dissertation: *Examining How 3D Modeling Could Influence High School Students' STEM Career Decision-Making*, under the direction of Professors Shiyan Jiang and Meghan Manfra.

T. Fulya Eyupoglu

Curriculum and Instruction

Dissertation: *The Impact of Metacognitive Strategy Training in a Game-Based Learning Environment for Fifth-Grade Science*, under the direction of Professor John Nietfeld.

June Williams Hurt

Curriculum and Instruction

Dissertation: *Perception, Agency, and Subversion: How North Carolina Gifted Education Teachers Deal with Lack of Diversity in their Gifted Education Programs*, under the direction of Professor Dennis Davis.

MASTER OF EDUCATION

Adult and Community College Education

James Nevell Brown, Jr.
Matthew Feuer
Eric Glenn Freeman, Jr.
Bruce Jenks
Samantha Blue Malinda
Paula Pedrosa Norris
Jacqueline Ellis Platt
Maryann Elizabeth Tyrer^{^^}

Clinical Mental Health Counseling

Richard Edward Aab
Celeste Allen
Samantha Arbella
Elliot Case
Nadia Josephine Crossno-Rodriguez
Meredith Ellen Drake
Courtney Leocle Hart
Bobby Hill
Dylan Christopher Hines
Amber Hayes Hinson
Sara Kathleen Innes
Antonique Jones
Ester Jusif Sade
Madeleine Rachel Krause
CarrieAnn Renee Lefsaker
Katherine Levinthal
Li-ting Lys Lin
Christina McCabe
Mackenzie Martin
Amy Merritt
Arden Nicole Norwood
Donal Kieran O'Carroll
Austin Garrett Pearce
Kiki Pineiro
Kristina Anne Platt
Christina Rachelle Rascoe
Kristin Caron Reddick
Rebekah Joy Shimer
Chandler Smith
Emma Socha
Joy Anitra Stucker
Sarah G. Szymanowski
Mara Thomas
Kelly Tucci
Luke Allan Wallenbeck
Melodie Anne Winter
Sherrie Yang

College Counseling and Student Development

Andi Dai
Ashley Ann Duemmler
Channing Merritt Edwards
Allison Nicole Gloekler
Emily Hoey
Mara Melendez-Doens
Jessica Nichol Riddell
Jennifer Williams Rudolph
Jasmine Monique Williams
Molly Wanwi Zhang

Higher Education Administration

Sabrina Lynn Balent
Jasmine Marie Barnes
Markita Briggs
Susan Chen
Tania Gavino-Lopez
Emily Koester
Rachael Anne Mathis
Brooke Stitt McCreedy
Jackie Mishoe
Nohemi Ramirez
Jaylah Desaraye Stewart
Gabriella Sinkovic Story
Ryan Katherine Velazquez
Wanya Trajhan Ward
Des Christopher Woods

School Counseling

Shellena Juanita Michele Atlas
India Monaye Bolden
Elizabeth Marie Brenneman
Lisa Dong
Mary Maxton Fowler
Jennifer Lyn Grunden
Valerie McCain
Patrick Burke McDade
Sara Elizabeth Morlock
Audrey Marie Roy
Salem McKenzie Williams

Training and Development

Thomas Melvin Bowling
Isaac Burns
James Cunningham, IV
James H. Ellis
Candice Andrea Graves
Hannah Marie Henschel
Susan Aimee Manassah
Lauren McGhee
Maggie Elaine Miller
Sara Devi Reese
Karen Richardson
Ben Rogers

Jessica Anne Schonberg
Glenn Alan Shearin
Bruce David Steinbicker, Jr.
Trevor R. Taylor

MASTER OF SCIENCE

Adult and Community College Education

Alex Patrick McGraw

MASTER OF SCHOOL ADMINISTRATION

Jessica Lauren Headrick Bailey
Jai'La Alexis Carmack
Britney Sade Chambers
Signe M. Coffey
Lisa Monique Bonner Davis
Hayley Gearheart
Nikia Simone Glass
Dillon Shaw Hamill
Marsha Harvey-Howard
Lorane Johnson
Brooke L. Little
Deric Scott Munoz
Haley Coker Owens
Alaina Ritter
Andrea Ruby
Ticia Scott
Ryan Elizabeth Thorne
Michael Joseph Warholik
LaVonda Chere'll Williams

SCIENCE, TECHNOLOGY, ENGINEERING,
AND MATHEMATICS EDUCATION

MASTER OF EDUCATION

Engineering and Technology Education

Mark Allen Bentley, II
Kathryn Hope Moon
Dongjian Shang

Mathematics Education

Rachel Joan Doggett
Meredith Anne Glover
Bethany Kristin Helms

Science Education

Morgan Claire Burk
Jessica Chestnut
Emma L. Droste
Zoe Kugler Isabella

MASTER OF ARTS IN TEACHING

Mathematics Education

Joshua Robert McDonald
Adam Charles Rosenberg

Science Education

Amelia Jane Barber[#]
Ashley Geer
Autumn Marie Hamm
Keegan Mary McQuillan
Erica Whitesock[#]

TEACHER EDUCATION
AND LEARNING SCIENCES

MASTER OF EDUCATION

Curriculum and Developmental Supervision

Davron Kwarmaine Rorie

Curriculum and Instruction

New Literacies and Global Learning, Reading

Kayla Belote-Perry
Shanna Clark Buckner
Kimberly Denise Cashwell
Quincey Hyatt Church
Kelsey Elizabeth Clarke
Valerie Alice LaVersa
Amy Lynette Leach
Emily Nicole Pruckno

Elementary Education

Abigail Barnes
Hannah Ferguson
Kristen Gioia-Perone
Carrie Marie Hoke
Courtney Elizabeth Johnson
Molly Catherine Kearns
Samantha Carolyn McNeill
Mary Elizabeth Raby
Rustina Dawn Thompson Sharpe
Lauren Swanson
Ashley Zatt

Learning Design and Technology

Shea Morgan Edwards
Michael Andrew Meehan
Rebecca Ellen Sitton
Hannah Elise Thornton

Special Education

Kimberly Ann Johnson
Michael Allen McNair, Jr.
Colleen Megan Troullis

MASTER OF ARTS IN TEACHING

Elementary Education

LaChelle Nicole Allen
Reilly Baysden
Angela Ross Bell
Shea Mitchell Brown
Jabreia Lashiary Dirton
Rachel Hearn
Phoebe Allegra Krisinski
Kristina Elizabeth Moss
Danielle Justina Pope
Kimberly Anne Scanlon
Kaitlyn Lee Schaffer
Drew Robert Sencabaugh
Elham Shameli
Olivia Spangenberg

English Education

Susanna Claire Beck
Emily Crusick
Brittany Ann Gaddis
Caroline Collier Jones
Elizabeth Ingram Peterson
Tiffany Francis Timmons¹

English as a Second Language

Stephanie R. Daniel
Daria Prokoshina

Middle Grades English Language Arts Education

Oneisha Rebecca Leonard

Middle Grades Social Studies Education

Meghan Lehr Olrich

Social Studies Education

Bailey McCall Adams
Ari Becker
Brittany Becker
Clancy Cloud Hecht-Nielsen
James Benton Henderson, III
Gage Cameron Jackson
Abigail Elizathe Leinfelder
Shannon Nicole McLaughlin
Ariel Kimberly Rivera
Emma Nicolle Stoltz
Zachery Truong

Zane Edwin Vermette
Braxton Thomas White¹
James Douglas White, Jr.

Special Education

Ijeoma Otutu Eke[#]
James Richard Garrett, II
Karen Irwin
Sherri Pauline Jenio
Louella Rose LePage
Brittany Marie Pixton
Brooke Juliette Source

SCIENCE, TECHNOLOGY, ENGINEERING, AND MATHEMATICS EDUCATION

BACHELOR'S DEGREES

Mathematics Education

Cameron Adams^{*}
Madison Lia Beddingfield^{****^#}
Morgan Alexandra Bellanger^{^#}
Shannon Elizabeth Carney^{+****±!}
Melanie Green¹
Daniela Herr[#]
Ainsley Ann Moore^{^#}
Hope D. Nguyen
Sarah Drew Phillips^{+***<^}
Kailey Rose Rea^{***^#}
Madelyn Creahan Tyrrell^{+****^#}
Katelyn Marie Vargas
Jenna Kathleen Varnell^{+****}
Alora Joy Wilson^{***#}

Science Education

Layla Grace Allen^{*^#}
Sarah Barbee¹
Lindsey Fuyu Birkemo^{**}
Jennifer Joelly Henderson^{*^#}
Abigail Grace Hester^{+****^#}
Spencer Christian Joseph[#]
Noemi Juarez
Emma Rose Miller^{***^#}
Protima Mukherjee^{+****!}
Destene Ann Smith^{**}
Tess Grace Stewart^{**}
Zachary VanHekken^{+****±!}
Kaitlynn Rose Wells^{***#}

Technology, Engineering, and Design Education

Catherine Lisetta Barbee
Samuel Aden Conklin^{*^}
Maxwell Cassius Cullett^{***>}

Ana Dobeck**
 Roman Martin Furze***
 Codie Glover**>
 Austin Davis Gunter***
 Allie Jones
 Edward Henry George Last-Powell†
 Brady Shane LaVoie***
 Emerson Anne Lawrence***#
 Kierney Faith Leonard***
 Joshua James Lessin
 Yuchen Liu**
 Conlan Duke Martin**
 Annie Ni*
 Aisha Raja**
 Virginia Ashraf Rezk***
 Michael Jesus Salgado*
 London Ja'nea Tolson**>
 Xingchen Wan**
 Christopher Andrew Wunder**

TEACHER EDUCATION
 AND LEARNING SCIENCES

BACHELOR'S DEGREES

Applied Education Studies

Aristotle Gradyn Bowles
 Sarah Estelle Conley**
 Clay Allen Craddock***
 Lindsay Elizabeth Davis**
 Taylor Nicole Gannon**
 Tanya Vonetta Gilharry
 Jake Daniel Hankley
 Selena Marie Harris***
 Alexandra Eslyn Husinko***
 Morgan Kelly
 Ariana Maria Purifoy***
 Kathryn Rebecca Reames
 Phoebe Louise Roberts*
 Megan Schwartz**
 Jonathan Silva
 Mohamed Thomas
 Jacqueline Patricia Verkuilen***

Elementary Education

Erika Allen***
 Alondra Badillo-Reyes***
 Mara Ashlynn Basile*
 Gabrielle Ann Breit***
 Ansley Lyn Brooks***
 Anna Elizabeth Burgess***^
 Rebekah Ann Byrd***
 Elizabeth Lea Cashwell***
 Hannah Elizabeth Colaco***

Macy Claire Cox**
 Catherine Maria Dean***±!#
 Kristen Victoria Frandock***
 Katherine Nicole Freije***
 Elizabeth Elena Gehringer***
 Jessi Ann Graham***#
 Hamdi Abdisalan Hashi†
 Mollie Leigh Hennings***
 Amy Elizabeth Henricks****^
 Eduardo Herrera-Rodriguez***
 Amber Nicole Hite***
 Mary Caprell Horton***
 Addison Clare Hughes***±#
 Lauren Jenkins**
 Alyssa Nicole Johnson^#
 Kianna Amari Johnson*^
 Emma Caroline Jones***
 Johnna Marie Jordan***
 Meghan M. Krol***^
 Amanda Ellen Lanier***
 Sophia Elizabeth Lathram***
 Baylie Rae Lucus***
 Ranine Aied Mohamed*
 Megan Eileen Mollin***
 Madison Faith Neal***#
 Kate Andres O'Neill***^#
 Sarah Camille Oakley***
 Erin Katelyn Ottavianelli***
 Tiphany Rose Parisi***
 Amber Noel Petrusa***^#
 Allie Jo Pulley***^
 Brenda Rios**
 Alison Lilly Paulina Schulze**
 Alexandra Lyn Simon***
 Garin Michael Sinkovic***
 Emily Anastasia Sistare***
 Holly Elizabeth Small**
 Lucy R. Smith***
 Anna Jordan Brown Stanford***^
 Elizabeth Alexis Stavrakakis***!
 Kailee Jaye Storie***^#
 Sophie Jordyn Teres***
 Angelica Valdivia-Avila***^
 Mariana Lucia Velarde Gainza*
 Brianna Danielle Webb***
 Margaret Irene Whitesell**
 Riley Lynn Wolven**
 Scott Eric Wylie*
 Morgan Yorton***^

Middle Grades Education

Oliver Gage Demer***
 Alexa Rae Hollingsworth**
 Ellison Haley Riley
 Alexander James Smith***

Directions to reception on Stafford Commons, the green space behind the Talley Student Union.

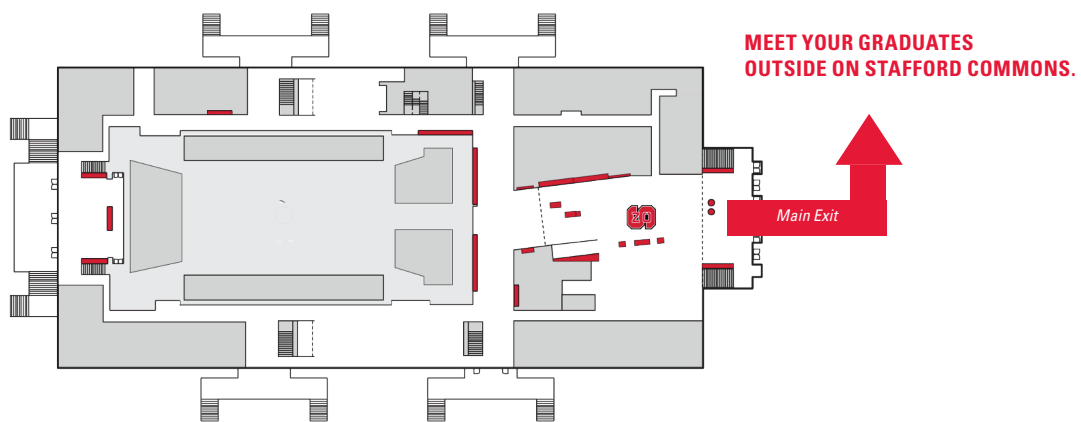

EDUCATIONAL LEADERSHIP, POLICY,
AND HUMAN DEVELOPMENT
FACULTY

Dr. Marc A. Grimmert,
Interim Department Head

Dr. Duane Akroyd
Dr. Jennifer B. Ayscue
Dr. Stanley B. Baker
Dr. Susan J. Barcinas
Dr. Krispin W. Barr
Dr. James E. Bartlett, II
Dr. Michelle E. Bartlett
Dr. Lisa R. Bass
Dr. Cristina Braga
Dr. Diane D. Chapman
Dr. Nicole Childs
Dr. Mary Ann Danowitz
Dr. Timothy A. Drake
Dr. Adria E. Dunbar
Dr. Anna J. Egalite
Dr. Kenneth L. Ender
Dr. M. Jayne Fleener
Dr. Bonnie C. Fusarelli
Dr. Lance D. Fusarelli
Dr. Joy Gaston Gayles
Dr. Peter A. Hessling
Dr. Chad D. Hoggan
Dr. Audrey J. Jaeger
Dr. Henry L. Johnson
Dr. Pooneh Lari
Dr. Michael Little
Dr. Rolanda Mitchell
Dr. Sylvia Nassar
Dr. Brea'n'a Parker
Dr. Lam Pham
Dr. Jose' A. Picart
Dr. Stephen R. Porter
Dr. Francine P. Riddick
Dr. Mary E. Rittling
Dr. Alyssa N. Rockenbach
Dr. Angela C. Smith
Dr. Terri Tilford
Dr. Robert G. Templin
Dr. Siu-Man Raymond Ting
Dr. Paul D. Umbach
Dr. Elizabeth Vincent
Dr. Michael E. Ward
Dr. Carrol L. Warren
Dr. Lesley G. Wirt
Dr. Tamara V. Young

DEAN EMERITA

Dr. Kathryn M. Moore

EMERITI FACULTY

Dr. George A. Baker, III
Dr. Paul F. Bitting
Dr. Edwin Gerler
Dr. J. Conrad Glass, Jr.
Dr. Lawrence K. Jones
Dr. Carol E. Kasworm
Dr. Elizabeth MacPhail-Wilcox
Dr. Julie G. McVay
Dr. Robert C. Serow
Dr. Norman A. Sprinthall
Dr. Raymond G. Taylor, Jr.

AFFILIATED FACULTY

Dr. Amanda H. Allen
Dr. Frim Ampaw

Dr. Patricia Ashley
Dr. Donna W. Bailey
Dr. Clinton Bolton
Dr. Bryan Brander
Dr. Crystal Brown
Dr. William Carver
Dr. Lisa Chapman
Dr. Jemilia S. Davis
Dr. Karrie G. Dixon
Dr. Pamela Eddy
Dr. James Ellerbe
Dr. Pamela Earp
Dr. Carol Figuers
Dr. Jean Fleming
Dr. Cynthia W. Geary
Dr. Paula Gentius
Dr. Bethany Glueck
Dr. Gary Green
Dr. Gayle Greene
Dr. Karen Haley
Dr. William C. Harrison
Dr. Garrett Hinshaw
Dr. Pamela B. Howze
Dr. William Ingram
Dr. Anthony Jackson
Dr. Cynthia W. Johnson
Dr. David Johnson
Dr. Linda Krute
Dr. Kathy D. Lohr
Dr. Deborah C. Luckadoo
Dr. Tim Luckadoo
Dr. Bruce Mallette
Dr. Bryan Martin
Dr. Audrey K. Martin-McCoy
Dr. Mildred Maxwell
Dr. Darryl D. McGraw
Dr. Dale McInnis
Dr. Larry Moneta
Dr. Sharon Morrissey
Dr. Pascal Mubenga
Dr. Martin Nadelman
Dr. Diana Oblinger
Dr. Tony O'Driscoll
Dr. Barry Olson
Dr. Amy B. Orders
Dr. Monica Osburn
Dr. Andy Overstreet
Dr. Colleen G. Paeplow
Dr. Randy Parker
Dr. Rodney Peterson
Dr. Donna T. Petherbridge
Dr. Rachel Porter
Dr. Eddie Price
Dr. R. Scott Ralls
Dr. Carol D. Raubenheimer
Dr. Donald L. Reichard
Dr. Lawrence Rouse
Dr. Ryan D. Rucker
Dr. Doneka Scott
Dr. Stephen Scott
Dr. Pamela Senegal
Dr. Kim Sepich
Dr. Trip Stallings
Dr. Jennifer Stanigar
Dr. Jason Taylor
Dr. Courtney H. Thornton
Dr. LaTricia Townsend
Dr. Richard Tyler-Walker
Dr. Millicent Valek

Dr. Sue Wasiolek
Dr. Jessica L. White
Dr. Dennis Wiese
Dr. Cathy Williams
Dr. Saundra Williams
Dr. Stelfanie Williams
Dr. Mary Ann Wolf
Dr. Carrie Zelna

SCIENCE, TECHNOLOGY,
ENGINEERING, AND MATHEMATICS
EDUCATION FACULTY

Dr. Aaron C. Clark,
Department Head

Dr. Robin K. Anderson
Dr. Margaret R. Blanchard
Dr. K.C. Busch
Dr. Sunghwan Byun
Dr. Cesar Delgado
Dr. Cameron DeLeon Denson
Dr. Cyndi Edgington
Ms. Mariam Elias
Dr. Ruby Ellis
Dr. Marissa M. Franzen
Dr. Karen F. Hollebrands
Dr. Carla C. Johnson
Dr. M. Gail Jones
Dr. Tamecia R. Jones
Dr. Erin Krupa
Dr. Hollylynne S. Lee
Dr. Brian Matthews
Dr. Steven L. Miller
Mr. John Parks Newby
Dr. Soonhye Park
Dr. Matt Reynolds
Mr. Erik Schettig
Dr. Eric Wiebe

EMERITI FACULTY

Dr. Theodore J. Branoff
Dr. Glenda S. Carter
Dr. Jere Confrey
Dr. Johnny L. Crow
Dr. William DeLuca
Dr. William J. Haynie
Dr. John Ronald Kolb
Dr. John E. Penick
Dr. Alice Y. Scales
Dr. William J. VanDerWall
Dr. Larry W. Watson
Dr. Robert E. Wenig
Dr. John H. Wheatley

AFFILIATED FACULTY

Dr. Tameshia S. Ballard
Dr. Jo-Ann Cohen

TEACHER EDUCATION AND
LEARNING SCIENCES FACULTY

Dr. Kevin M. Oliver,
Department Head

Dr. Chandra Alston
Ms. April Y. Bartley
Dr. Candy M. Beal
Dr. Drinda Bengé
Dr. Vandna Bindra
Dr. Christy M. Byrd
Dr. Sarah E. Cannon

Dr. Sarah J. Carrier
Dr. Maria R. Coady
Dr. Cathy L. Crossland
Dr. Dennis S. Davis
Dr. Deniz Eseryel
Dr. Michelle M. Falter
Dr. Valerie N. Faulkner
Dr. DeLeon L. Gray
Dr. Jill F. Grifenhagen
Dr. Kristin F. Hoffmann
Dr. Jessica H. Hunt
Dr. Micha J. Jeffries
Dr. Shiyang Jiang
Dr. Jill S. Jones
Ms. Betsy Knight
Dr. Joanna G. Koch
Ms. Kari Kuebel
Dr. Crystal C. Lee
Dr. John K. Lee
Dr. Jordan Lukins
Dr. Meghan M. Manfra
Dr. Patricia L. Marshall
Dr. Samantha Marshall
Dr. Florence Martin
Dr. Paula J. McAvoy
Dr. Julia O. McKeown
Dr. James Minogue
Dr. John L. Nietfeld
Dr. Amato Nocera
Dr. Jamie N. Pearson
Dr. Jackie Relyea
Dr. Terrell Robinson
Ms. Melanie W. Smith
Dr. Paola Sztajn
Dr. Margareta M. Thomson
Mr. Keith T. Walkowiak
Dr. Temple A. Walkowiak
Dr. Angela M. Wiseman
Dr. Carl A. Young

EMERITI FACULTY

Dr. Douglas A. Cullinan
Dr. Barbara J. Fox
Dr. Susan S. Osborne
Dr. Barbara M. Parramore
Dr. Carol A. Pope
Dr. Ruie J. Pritchard
Dr. Edward J. Sabornie
Dr. Hiller A. Spires
Dr. Samuel S. Snyder
Dr. Lois Thies-Sprinthall
Dr. Ellen S. Vasu

AFFILIATED FACULTY

Dr. Leah Bug
Dr. Jody L. Clevén
Dr. Marcia S. Davis
Dr. Jessica DeCuir-Gunby
Dr. Lisa G. Hervey
Dr. Ondrej Pesout
Dr. Erin T. Horne
Dr. Shaun B. Kellogg
Dr. Glennda McKeithan
Dr. Whitney N. McCoy
Dr. Melissa Raspberry
Dr. James R. Smith, Jr.

NC STATE
College of Education



Mission

The College of Education is a voice of innovation for learning across the lifespan.
We prepare professionals who educate and lead.
Our inquiry and practice reflect integrity, a commitment to social justice, and the value of diversity in a global community.

Vision

The College of Education will lead the way in North Carolina in increasing opportunities for success in education and in reducing achievement gaps.

College of Education Deans' Cabinet

Paola Sztajn, Dean
Karen Hollebrands, Associate Dean for Research and Innovation
Erin Horne, Assistant Dean for Assessment and Professional Education
Hector Junco, Assistant Dean for Operations
John K. Lee, Associate Dean for Faculty and Academic Affairs
Anona Smith Williams, Associate Dean for Student Success

NC STATE UNIVERSITY
College of Education



ced.ncsu.edu

