

**NC STATE UNIVERSITY** College of Education

# COMMENCEMENT CEREMONY



May 5, 2023

Educational Leadership, Policy, and Human Development  
Science, Technology, Engineering, and Mathematics Education  
Teacher Education and Learning Sciences



## Order of Exercises

*Processional*

### **Welcome**

**Dr. Paola Sztajn**  
Dean

### **Introduction of Student Speaker**

**Dr. Karen Hollebrands**  
Associate Dean

### **Charge to the Graduate Students**

**Abraham Luis Dones**  
Adult and Community College Education

### **Presentation of Doctoral Degrees**

Educational Leadership, Policy, and Human Development

**Dr. Karen Hollebrands**

Science, Technology, Engineering, and Mathematics Education

**Dr. Marc A. Grimmert**  
Interim Department Head

Teacher Education and Learning Sciences

**Dr. Aaron C. Clark**  
Department Head

**Dr. Kevin M. Oliver**  
Department Head

### **Presentation of Outstanding Doctoral Dissertation Awards**

**Dr. Karen Hollebrands**

### **Presentation of Master's Degrees**

Educational Leadership, Policy, and Human Development

**Dr. John K. Lee**  
Associate Dean

Science, Technology, Engineering, and Mathematics Education

**Dr. Marc A. Grimmert**

Teacher Education and Learning Sciences

**Dr. Aaron C. Clark**

**Dr. Kevin M. Oliver**

### **Introduction of Student Speaker**

**Dr. Anona Smith Williams**  
Associate Dean

### **Charge to the Undergraduate Students**

**Kailee Jaye Storie**  
Elementary Education

### **Presentation of Undergraduate Degrees**

Science, Technology, Engineering, and Mathematics Education

**Dr. John K. Lee**

Teacher Education and Learning Sciences

**Dr. Aaron C. Clark**

**Dr. Kevin M. Oliver**

### **Special Recognitions**

**Dr. Anona Smith Williams**

### **Closing Remarks**

**Dr. Paola Sztajn**

*Reception to follow in Stafford Commons, Talley Student Union*

EDUCATIONAL LEADERSHIP, POLICY,  
AND HUMAN DEVELOPMENT

## DOCTOR OF EDUCATION

### Gabrielle McCutchen

#### Adult and Community College Education

Dissertation: *Faculty Perceptions of Their Role and Their Institution's Role in Closing Equity Gaps*, under the direction of Professor Chad Hoggan.

### Abraham Luis Dones

#### Adult and Community College Education

Dissertation: *Understanding the Enrollment and Persistence Experiences of First Time in College Latinx Students at a Community College in the South Region of the United States*, under the direction of Professors Audrey Jaeger and Carrol Warren.

### Alma Rodriguez Jones

#### Community College Leadership

Dissertation: *Exploring Mental Health Literacy Among Faculty at a Rural Community College After the COVID Pandemic*, under the direction of Professor Carrol Warren.

### Amy J. Mahle

#### Community College Leadership

Dissertation: *Exploring Community College Presidents' Communication with Employees During a Global Pandemic*, under the direction of Professor Carrol Warren.

### Britney Le Anne Shawley

#### Community College Leadership

Dissertation: *Building a Culture of Support: A Narrative Inquiry Study of the Lived Experiences of Employer Support of North Carolina Community College Employees Enrolled in Graduate Coursework*, under the direction of Professor Carrol Warren.

### Russell Lee Parker

#### Community College Leadership

Dissertation: *Key Partnership Roles in High-Quality Youth Pre-Apprenticeship Programs*, under the direction of Professors James Bartlett and Michelle Bartlett.

### Jennifer LaDue

#### Community College Leadership

Dissertation: *The Lived Experiences of North Carolina Female Community College Presidents Around Mentoring and Being Mentored*, under the direction of Professor Michelle Bartlett.

### Lisa Watson Bowen

#### Educational Administration and Supervision

Dissertation: *Bullying of Middle School Students with Autism Spectrum Disorders: A Qualitative Exploration of Prevalence and Perceptions of Students, Parents, and Teachers*, under the direction of Professor Michael Ward.

## DOCTOR OF PHILOSOPHY

### Shawn Christopher Wright-Haertel

#### Educational Leadership, Policy, and Human Development Counseling and Counselor Education

Dissertation: *The Relationship Between Disclosure and Sexual Orientation of Black Men Who Sleep with Men and their Attachment Styles*, under the direction of Professor Stanley Baker.

### Karimah L'trelle Midgette

#### Educational Leadership, Policy, and Human Development Counseling and Counselor Education

Dissertation: *Understanding the Protective Factors Employed by African American Women Diagnosed with Female Infertility*, under the direction of Professor Stanley Baker.

### Alyssa Nicole Anderson

#### Educational Leadership, Policy, and Human Development Adult and Lifelong Education

Dissertation: *A Case Study of Nutrition Educators' Perspectives on the Delivery of Virtual Community Nutrition Programming*, under the direction of Professor Susan Barcinas.

### Chrystal Louise Coble

#### Educational Leadership, Policy, and Human Development Adult and Lifelong Education

Dissertation: *A Narrative Inquiry of Queer Graduate Student Experiences with Classroom Climate*, under the direction of Professor Michelle Bartlett.

### Jeremy Allen Gilmore

#### Educational Leadership, Policy, and Human Development Adult and Lifelong Education

Dissertation: *Blessings and Cursings: A Phenomenological Study on the Usage of Profanity in Clinical Pastoral Education*, under the direction of Professor Jayne Fleener.

### Elizabeth Ashlyn Locklear<sup>^^</sup>

#### Educational Leadership, Policy, and Human Development Adult and Lifelong Education

Dissertation: *Educating for Uncertainty: A Qualitative Study on Preparing Future-Ready Physicians through Master Adaptive Learning*, under the direction of Professor Jayne Fleener.

### LaTisha Aulette Brown

#### Educational Leadership, Policy, and Human Development Counseling and Counselor Education

Dissertation: *Exploring Systemic Factors Impacting Stress in Black Parents of Autistic Children*, under the direction of Professors Adria Dunbar and Jamie Pearson.

### Bredell Keith Moody

#### Educational Leadership, Policy, and Human Development Counseling and Counselor Education

Dissertation: *Bearing Witness to Terror and Triumph: A Narrative Inquiry into Black Men's Healing after Police Brutality*, under the direction of Professor Marc A. Grimmer.

### Matthew Lengen

#### Educational Leadership, Policy, and Human Development Higher Education

Dissertation: *Binding Admission at Private Higher Education Institutions and Implications for Tuition Revenue and Discounting*, under the direction of Professors Paul Umbach and Steve Porter.

### Gordon Wilson Maples

#### Educational Leadership, Policy, and Human Development Higher Education Opportunity, Equity, and Justice

Dissertation: *Student Religious Accommodation Policies and Non-Christian College Student Perceptions of Institutional Support: A Mixed Methods Dissertation*, under the direction of Professor Alyssa Rockenbach.

<sup>^^</sup>December 2022 graduate <sup>^</sup>Outstanding Dissertation Award <sup>></sup>Epsilon Pi Tau <sup>#</sup>Teaching Fellow

**Chelsea Tashea Smith**

Educational Leadership, Policy, and Human Development

Higher Education Opportunity, Equity, and Justice

Dissertation: *Refuge from the Storm: A Case Study of Black Womens' Experiences in STEM Peer and Research Co-Curricular Programs at a PWI in the Southeast.*, under the direction of Professor Joy Gaston Gayles.

**Jordan Christopher Hale**

Educational Research and Policy Analysis

Higher Education Administration

Dissertation: *The Role of the Coach in the Storied Experiences of Black Male College Student Athletes*, under the direction of Professor Joy Gaston Gayles.

**Drew Michael Goodson**

Educational Research and Policy Analysis

Adult and Community College Education

Dissertation: *Factors Associated with Upward Transfer at a Rural Community College*, under the direction of Professor Duane Akroyd.

SCIENCE, TECHNOLOGY, ENGINEERING,  
AND MATHEMATICS EDUCATION

**DOCTOR OF PHILOSOPHY****Justin Charles Egresitz<sup>2</sup>**

Learning and Teaching in STEM, Engineering and Technology Education

Dissertation: *Think and Do: A Phenomenological Investigation into Student Motivation toward Making and Doing*, under the direction of Professor Aaron Clark.

**Jerome Zegaigbe Amedu**

Learning and Teaching in STEM, Mathematics and Statistics Education

Dissertation: *Examining Mathematics Teachers' Perceptions of the Effects of Informal Learning on Teacher Knowledge and Practices: An Explanatory, Sequential Mixed-Methods Study*, under the direction of Professors Karen Hollebrands and Ruby L. Ellis.

**Latoya Lynn Brewer**

Learning and Teaching in STEM, Mathematics and Statistics Education

Dissertation: *Analyzing Relationships among College Students' Interactions with Instructional Videos and their Mathematics Learning: A Qualitative Multi-Case Study*, under the direction of Professor Karen Hollebrands.

**David Jerome Stokes**

Learning and Teaching in STEM, Mathematics and Statistics Education

Dissertation: *Examining Sociocritical and Agency Building Educational Experiences in STEM and their Potential to Change Patterns in STEM Underrepresentation*, under the direction of Professor Hollylynne Lee.

**Karen Marie Collier<sup>2</sup>**

Learning and Teaching in STEM, Science Education

Dissertation: *Exploring and Measuring Influential Factors for Graduate Student Success*, under the direction of Professor Margaret Blanchard.

**Madeline Tate Hinckle**

Learning and Teaching in STEM, Science Education

Dissertation: *Integrating Computer Science and Computational Thinking into Middle School Science: Exploring the Impacts of a Computational Thinking Focused Research Practice Partnership*, under the direction of Professor Eric Wiebe.

**Mwenda Oluwatoyin Kudumu-Biggs**

Learning and Teaching in STEM, Science Education

Dissertation: *The Perceptions and Practices of Informal Science Educators Regarding Culturally Relevant Education in Science Centers*, under the direction of Professors K.C. Busch and Soonhye Park.

**Emma Jane Refvem**

Learning and Teaching in STEM, Science Education

Dissertation: *Science Instructional Coaches: Content Expertise, Beliefs, Motivation, and Contexts*, under the direction of Professor Gail Jones.

**Rebecca Vee Ward**

Learning and Teaching in STEM, Science Education

Dissertation: *Communicator and Reader Perspectives of Climate Change Visual Displays*, under the direction of Professor Gail Jones.

TEACHER EDUCATION  
AND LEARNING SCIENCES

**DOCTOR OF PHILOSOPHY****Lili Wang**

Teacher Education and Learning Sciences

Literacy and English Language Arts Education

Dissertation: *A Mixed-Methods Study on the Technology Use of Chinese EFL Teachers in High School Classrooms*, under the direction of Professor Hiller Spires.

**Danielle Robin Scharen<sup>2</sup>**

Teacher Education and Learning Sciences

Elementary Education in Mathematics and Science

Dissertation: *Examining Elementary Pre-service Teachers' Use of the Touch-Talk-Text Science Instructional Model: An Exploratory Case Study Analysis*, under the direction of Professor Sarah Carrier.

**Cigdem Meral**

Teacher Education and Learning Sciences

Learning Design and Technology

Dissertation: *Examining How 3D Modeling Could Influence High School Students' STEM Career Decision-Making*, under the direction of Professors Shiyan Jiang and Meghan Manfra.

**T. Fulya Eyupoglu**

Curriculum and Instruction

Dissertation: *The Impact of Metacognitive Strategy Training in a Game-Based Learning Environment for Fifth-Grade Science*, under the direction of Professor John Nietfeld.

**June Williams Hurt**

Curriculum and Instruction

Dissertation: *Perception, Agency, and Subversion: How North Carolina Gifted Education Teachers Deal with Lack of Diversity in their Gifted Education Programs*, under the direction of Professor Dennis Davis.

## MASTER OF EDUCATION

### Adult and Community College Education

James Nevell Brown, Jr.  
Matthew Feuer  
Eric Glenn Freeman, Jr.  
Bruce Jenks  
Samantha Blue Malinda  
Paula Pedrosa Norris  
Jacqueline Ellis Platt  
Maryann Elizabeth Tyrer<sup>^^</sup>

### Clinical Mental Health Counseling

Richard Edward Aab  
Celeste Allen  
Samantha Arbella  
Elliot Case  
Nadia Josephine Crossno-Rodriguez  
Meredith Ellen Drake  
Courtney Leocle Hart  
Bobby Hill  
Dylan Christopher Hines  
Amber Hayes Hinson  
Sara Kathleen Innes  
Antonique Jones  
Ester Jusif Sade  
Madeleine Rachel Krause  
CarrieAnn Renee Lefsaker  
Katherine Levinthal  
Li-ting Lys Lin  
Christina McCabe  
Mackenzie Martin  
Amy Merritt  
Arden Nicole Norwood  
Donal Kieran O'Carroll  
Austin Garrett Pearce  
Kiki Pineiro  
Kristina Anne Platt  
Christina Rachelle Rascoe  
Kristin Caron Reddick  
Rebekah Joy Shimer  
Chandler Smith  
Emma Socha  
Joy Anitra Stucker  
Sarah G. Szymanowski  
Mara Thomas  
Kelly Tucci  
Luke Allan Wallenbeck  
Melodie Anne Winter  
Sherrie Yang

### College Counseling and Student Development

Andi Dai  
Ashley Ann Duemmler  
Channing Merritt Edwards  
Allison Nicole Gloekler  
Emily Hoey  
Mara Melendez-Doens  
Jessica Nichol Riddell  
Jennifer Williams Rudolph  
Jasmine Monique Williams  
Molly Wanwi Zhang

### Higher Education Administration

Sabrina Lynn Balent  
Jasmine Marie Barnes  
Markita Briggs  
Susan Chen  
Tania Gavino-Lopez  
Emily Koester  
Rachael Anne Mathis  
Brooke Stitt McCready  
Jackie Mishoe  
Nohemi Ramirez  
Jaylah Desaray Stewart  
Gabriella Sinkovic Story  
Ryan Katherine Velazquez  
Wanya Trajhan Ward  
Des Christopher Woods

### School Counseling

Shellena Juanita Michele Atlas  
India Monaye Bolden  
Elizabeth Marie Brenneman  
Lisa Dong  
Mary Maxton Fowler  
Jennifer Lyn Grunden  
Valerie McCain  
Patrick Burke McDade  
Sara Elizabeth Morlock  
Audrey Marie Roy  
Salem McKenzie Williams

### Training and Development

Thomas Melvin Bowling  
Isaac Burns  
James Cunningham, IV  
James H. Ellis  
Candice Andrea Graves  
Hannah Marie Henschel  
Susan Aimee Manassah  
Lauren McGhee  
Maggie Elaine Miller  
Sara Devi Reese  
Karen Richardson  
Ben Rogers

Jessica Anne Schonberg  
Glenn Alan Shearin  
Bruce David Steinbicker, Jr.  
Trevor R. Taylor

## MASTER OF SCIENCE

### Adult and Community College Education

Alex Patrick McGraw

## MASTER OF SCHOOL ADMINISTRATION

Jessica Lauren Headrick Bailey  
Jai'La Alexis Carmack  
Britney Sade Chambers  
Signe M. Coffey  
Lisa Monique Bonner Davis  
Hayley Gearheart  
Nikia Simone Glass  
Dillon Shaw Hamill  
Marsha Harvey-Howard  
Lorane Johnson  
Brooke L. Little  
Deric Scott Munoz  
Haley Coker Owens  
Alaina Ritter  
Andrea Ruby  
Ticia Scott  
Ryan Elizabeth Thorne  
Michael Joseph Warholik  
LaVonda Chere'll Williams

SCIENCE, TECHNOLOGY, ENGINEERING,  
AND MATHEMATICS EDUCATION

## MASTER OF EDUCATION

### Engineering and Technology Education

Mark Allen Bentley, II  
Kathryn Hope Moon  
Dongjian Shang

### Mathematics Education

Rachel Joan Doggett  
Meredith Anne Glover  
Bethany Kristin Helms

### Science Education

Morgan Claire Burk  
Jessica Chestnut  
Emma L. Droste  
Zoe Kugler Isabella

## MASTER OF ARTS IN TEACHING

### Mathematics Education

Joshua Robert McDonald  
Adam Charles Rosenberg

### Science Education

Amelia Jane Barber<sup>#</sup>  
Ashley Geer  
Autumn Marie Hamm  
Keegan Mary McQuillan  
Erica Whitesock<sup>#</sup>

TEACHER EDUCATION  
AND LEARNING SCIENCES

## MASTER OF EDUCATION

### Curriculum and Developmental Supervision

Davron Kwarmaine Rorie

### Curriculum and Instruction

#### New Literacies and Global Learning, Reading

Kayla Belote-Perry  
Shanna Clark Buckner  
Kimberly Denise Cashwell  
Quincey Hyatt Church  
Kelsey Elizabeth Clarke  
Valerie Alice LaVersa  
Amy Lynette Leach  
Emily Nicole Pruckno

### Elementary Education

Abigail Barnes  
Hannah Ferguson  
Kristen Gioia-Perone  
Carrie Marie Hoke  
Courtney Elizabeth Johnson  
Molly Catherine Kearns  
Samantha Carolyn McNeill  
Mary Elizabeth Raby  
Rustina Dawn Thompson Sharpe  
Lauren Swanson  
Ashley Zatt

### Learning Design and Technology

Shea Morgan Edwards  
Michael Andrew Meehan  
Rebecca Ellen Sitton  
Hannah Elise Thornton

### **Special Education**

Kimberly Ann Johnson  
Michael Allen McNair, Jr.  
Colleen Megan Troullis

## **MASTER OF ARTS IN TEACHING**

### **Elementary Education**

LaChelle Nicole Allen  
Reilly Baysden  
Angela Ross Bell  
Shea Mitchell Brown  
Jabreia Lashiary Dirton  
Rachel Hearn  
Phoebe Allegra Krisinski  
Kristina Elizabeth Moss  
Danielle Justina Pope  
Kimberly Anne Scanlon  
Kaitlyn Lee Schaffer  
Drew Robert Sencabaugh  
Elham Shameli  
Olivia Spangenberg

### **English Education**

Susanna Claire Beck  
Emily Crusick  
Brittany Ann Gaddis  
Caroline Collier Jones  
Elizabeth Ingram Peterson  
Tiffany Francis Timmons<sup>1</sup>

### **English as a Second Language**

Stephanie R. Daniel  
Daria Prokoshina

### **Middle Grades English Language Arts Education**

Oneisha Rebecca Leonard

### **Middle Grades Social Studies Education**

Meghan Lehr Olrich

### **Social Studies Education**

Bailey McCall Adams  
Ari Becker  
Brittany Becker  
Clancy Cloud Hecht-Nielsen  
James Benton Henderson, III  
Gage Cameron Jackson  
Abigail Elizathe Leinfelder  
Shannon Nicole McLaughlin  
Ariel Kimberly Rivera  
Emma Nicolle Stoltz  
Zachery Truong

Zane Edwin Vermette  
James Douglas White, Jr.

### **Special Education**

Ijeoma Otutu Eke<sup>#</sup>  
James Richard Garrett, II  
Karen Irwin  
Sherri Pauline Jenio  
Louella Rose LePage  
Brittany Marie Pixton  
Brooke Juliette Source

## **SCIENCE, TECHNOLOGY, ENGINEERING, AND MATHEMATICS EDUCATION**

## **BACHELOR'S DEGREES**

### **Mathematics Education**

Cameron Adams<sup>\*</sup>  
Madison Lia Beddingfield<sup>\*\*\*\*^#</sup>  
Morgan Alexandra Bellanger<sup>^#</sup>  
Shannon Elizabeth Carney<sup>+\*\*\*±!</sup>  
Melanie Green<sup>1</sup>  
Daniela Herr<sup>#</sup>  
Ainsley Ann Moore<sup>^#</sup>  
Hope D. Nguyen  
Sarah Drew Phillips<sup>+\*\*\*<^</sup>  
Kailey Rose Rea<sup>\*\*\*^#</sup>  
Madelyn Creahan Tyrrell<sup>+\*\*\*\*^#</sup>  
Katelyn Marie Vargas  
Jenna Kathleen Varnell<sup>+\*\*\*</sup>  
Alora Joy Wilson<sup>\*\*\*#</sup>

### **Science Education**

Layla Grace Allen<sup>\*^#</sup>  
Sarah Barbee<sup>1</sup>  
Lindsey Fuyu Birkemo<sup>\*\*</sup>  
Jennifer Joelly Henderson<sup>\*^#</sup>  
Abigail Grace Hester<sup>\*\*\*^#</sup>  
Spencer Christian Joseph<sup>#</sup>  
Noemi Juarez  
Emma Rose Miller<sup>\*\*\*^#</sup>  
Protima Mukherjee<sup>+\*\*\*!</sup>  
Destene Ann Smith<sup>\*\*</sup>  
Tess Grace Stewart<sup>\*\*</sup>  
Zachary VanHekken<sup>+\*\*\*±!</sup>  
Kaitlynn Rose Wells<sup>\*\*\*#</sup>

### **Technology, Engineering, and Design Education**

Catherine Lisetta Barbee  
Samuel Aden Conklin<sup>\*^</sup>  
Maxwell Cassius Cullett<sup>\*\*\*></sup>



Ana Dobeck\*\*  
 Roman Martin Furze\*\*\*  
 Codie Glover\*\*>  
 Austin Davis Gunter\*\*\*  
 Allie Jones  
 Edward Henry George Last-Powell†  
 Brady Shane LaVoie\*\*\*  
 Emerson Anne Lawrence\*\*\*#  
 Kierney Faith Leonard\*\*\*  
 Joshua James Lessin  
 Yuchen Liu\*\*  
 Conlan Duke Martin\*\*  
 Annie Ni†\*  
 Aisha Raja\*\*  
 Virginia Ashraf Rezk\*\*\*  
 Michael Jesus Salgado\*  
 London Ja'nea Tolson\*\*>  
 Xingchen Wan\*\*  
 Christopher Andrew Wunder\*\*

## TEACHER EDUCATION AND LEARNING SCIENCES

### BACHELOR'S DEGREES

#### Applied Education Studies

Aristotle Grady Bowles  
 Sarah Estelle Conley\*\*  
 Clay Allen Craddock\*\*\*  
 Lindsay Elizabeth Davis\*\*  
 Taylor Nicole Gannon\*\*  
 Tanya Vonetta Gilharry  
 Jake Daniel Hankley  
 Selena Marie Harris\*\*\*  
 Alexandra Eslyn Husinko\*\*\*  
 Morgan Kelly  
 Ariana Maria Purifoy\*\*\*  
 Kathryn Rebecca Reames  
 Phoebe Louise Roberts\*  
 Megan Schwartz\*\*  
 Jonathan Silva  
 Mohamed Thomas  
 Jacqueline Patricia Verkuilen\*\*\*

#### Elementary Education

Erika Allen\*\*\*  
 Alondra Badillo-Reyes\*\*\*  
 Mara Ashlynn Basile\*  
 Gabrielle Ann Breit\*\*\*  
 Ansley Lyn Brooks\*\*\*  
 Anna Elizabeth Burgess\*\*\*^  
 Rebekah Ann Byrd\*\*\*  
 Elizabeth Lea Cashwell\*\*\*  
 Hannah Elizabeth Colaco\*\*\*

Macy Claire Cox\*\*  
 Catherine Maria Dean\*\*\*±!#  
 Kristen Victoria Frandock\*\*\*  
 Katherine Nicole Freije\*\*\*  
 Elizabeth Elena Gehringer\*\*\*  
 Jessi Ann Graham\*\*\*#  
 Hamdi Abdisalan Hashi\*  
 Mollie Leigh Hennings\*\*\*  
 Amy Elizabeth Henricks\*\*\*^  
 Eduardo Herrera-Rodriguez\*\*\*  
 Amber Nicole Hite\*\*\*  
 Mary Caprell Horton\*\*\*  
 Addison Clare Hughes\*\*\*±#  
 Lauren Jenkins\*\*  
 Alyssa Nicole Johnson^#  
 Kianna Amari Johnson\*^  
 Emma Caroline Jones\*\*\*  
 Johnna Marie Jordan\*\*\*  
 Meghan M. Krol\*\*\*^  
 Amanda Ellen Lanier\*\*\*  
 Sophia Elizabeth Lathram\*\*\*  
 Baylie Rae Lucas\*\*\*  
 Ranine Aied Mohamed\*  
 Megan Eileen Mollin\*\*\*  
 Madison Faith Neal\*\*\*#  
 Kate Andres O'Neill\*\*\*^#  
 Sarah Camille Oakley\*\*\*  
 Erin Katelyn Ottavianelli\*\*\*  
 Tiphany Rose Parisi\*\*\*  
 Amber Noel Petrusa\*\*\*^#  
 Allie Jo Pulley\*\*\*^  
 Brenda Rios\*\*  
 Alison Lilly Paulina Schulze\*\*  
 Alexandra Lyn Simon\*\*\*  
 Garin Michael Sinkovic\*\*\*  
 Emily Anastasia Sistare\*\*\*  
 Holly Elizabeth Small\*\*  
 Lucy R. Smith\*\*\*  
 Anna Jordan Brown Stanford\*\*\*^  
 Elizabeth Alexis Stavrakakis\*\*\*!  
 Kailee Jaye Storie\*\*\*^#  
 Sophie Jordyn Teres\*\*\*  
 Angelica Valdivia-Avila\*\*\*^  
 Mariana Lucia Velarde Gainza\*  
 Brianna Danielle Webb\*\*\*  
 Margaret Irene Whitesell\*\*  
 Riley Lynn Woven\*\*\*  
 Scott Eric Wylie\*  
 Morgan Yorton\*\*\*^

#### Middle Grades Education

Oliver Gage Demer\*\*\*  
 Alexa Rae Hollingsworth\*\*  
 Ellison Haley Riley  
 Alexander James Smith\*\*\*



*Directions to reception on Stafford Commons, the green space behind the Talley Student Union.*

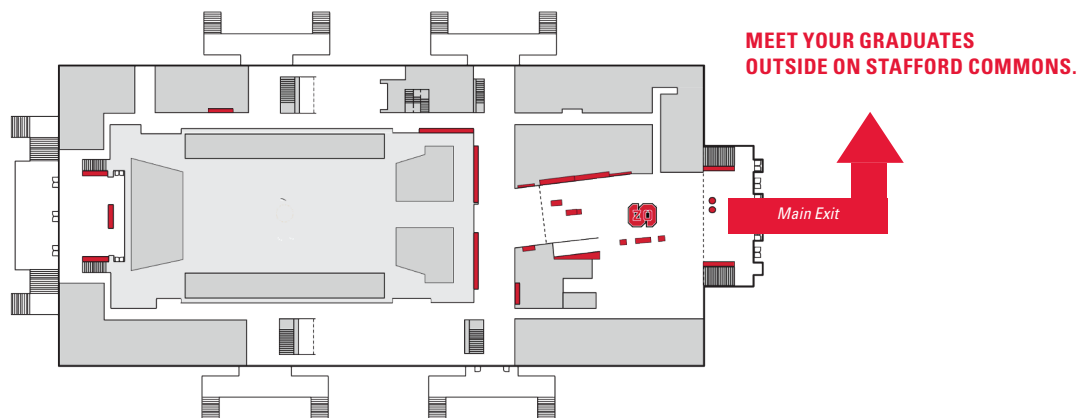

EDUCATIONAL LEADERSHIP, POLICY,  
AND HUMAN DEVELOPMENT  
FACULTY

**Dr. Marc A. Grimmett,**  
**Interim Department Head**

Dr. Duane Akroyd  
Dr. Jennifer B. Ayscue  
Dr. Stanley B. Baker  
Dr. Susan J. Barcinas  
Dr. Krispin W. Barr  
Dr. James E. Bartlett, II  
Dr. Michelle E. Bartlett  
Dr. Lisa R. Bass  
Dr. Cristina Braga  
Dr. Diane D. Chapman  
Dr. Nicole Childs  
Dr. Mary Ann Danowitz  
Dr. Timothy A. Drake  
Dr. Adria E. Dunbar  
Dr. Anna J. Egalite  
Dr. Kenneth L. Ender  
Dr. M. Jayne Fleener  
Dr. Bonnie C. Fusarelli  
Dr. Lance D. Fusarelli  
Dr. Joy Gaston Gayles  
Dr. Peter A. Hessling  
Dr. Chad D. Hoggan  
Dr. Audrey J. Jaeger  
Dr. Henry L. Johnson  
Dr. Pooneh Lari  
Dr. Michael Little  
Dr. Rolanda Mitchell  
Dr. Sylvia Nassar  
Dr. Brean'a Parker  
Dr. Lam Pham  
Dr. Jose' A. Picart  
Dr. Stephen R. Porter  
Dr. Francine P. Riddick  
Dr. Mary E. Rittling  
Dr. Alyssa N. Rockenbach  
Dr. Angela C. Smith  
Dr. Terri Tilford  
Dr. Robert G. Templin  
Dr. Siu-Man Raymond Ting  
Dr. Paul D. Umbach  
Dr. Elizabeth Vincent  
Dr. Michael E. Ward  
Dr. Carrol L. Warren  
Dr. Lesley G. Wirt  
Dr. Tamara V. Young

**DEAN EMERITA**

Dr. Kathryn M. Moore

**EMERITI FACULTY**

Dr. George A. Baker, III  
Dr. Paul F. Bitting  
Dr. Edwin Gerler  
Dr. J. Conrad Glass, Jr.  
Dr. Lawrence K. Jones  
Dr. Carol E. Kasworm  
Dr. Elizabeth MacPhail-Wilcox  
Dr. Julie G. McVay  
Dr. Robert C. Serow  
Dr. Norman A. Sprinthal  
Dr. Raymond G. Taylor, Jr.

**AFFILIATED FACULTY**

Dr. Amanda H. Allen  
Dr. Frim Ampaw

Dr. Patricia Ashley  
Dr. Donna W. Bailey  
Dr. Clinton Bolton  
Dr. Bryan Brander  
Dr. Crystal Brown  
Dr. William Carver  
Dr. Lisa Chapman  
Dr. Jemilia S. Davis  
Dr. Karrie G. Dixon  
Dr. Pamela Eddy  
Dr. James Ellerbe  
Dr. Pamela Earp  
Dr. Carol Figuers  
Dr. Jean Fleming  
Dr. Cynthia W. Geary  
Dr. Paula Gentius  
Dr. Bethany Glueck  
Dr. Gary Green  
Dr. Gayle Greene  
Dr. Karen Haley  
Dr. William C. Harrison  
Dr. Garrett Hinshaw  
Dr. Pamela B. Howze  
Dr. William Ingram  
Dr. Anthony Jackson  
Dr. Cynthia W. Johnson  
Dr. David Johnson  
Dr. Linda Krute  
Dr. Kathy D. Lohr  
Dr. Deborah C. Luckadoo  
Dr. Tim Luckadoo  
Dr. Bruce Mallette  
Dr. Bryan Martin  
Dr. Audrey K. Martin-McCoy  
Dr. Mildred Maxwell  
Dr. Darryl D. McGraw  
Dr. Dale McInnis  
Dr. Larry Moneta  
Dr. Sharon Morrissey  
Dr. Pascal Mubenga  
Dr. Martin Nadelman  
Dr. Diana Oblinger  
Dr. Tony O'Driscoll  
Dr. Barry Olson  
Dr. Amy B. Orders  
Dr. Monica Osburn  
Dr. Andy Overstreet  
Dr. Colleen G. Paeplow  
Dr. Randy Parker  
Dr. Rodney Peterson  
Dr. Donna T. Petherbridge  
Dr. Rachel Porter  
Dr. Eddie Price  
Dr. R. Scott Ralls  
Dr. Carol D. Raubenheimer  
Dr. Donald L. Reichard  
Dr. Lawrence Rouse  
Dr. Ryan D. Rucker  
Dr. Doneka Scott  
Dr. Stephen Scott  
Dr. Pamela Senegal  
Dr. Kim Sepich  
Dr. Trip Stallings  
Dr. Jennifer Stanigar  
Dr. Jason Taylor  
Dr. Courtney H. Thornton  
Dr. LaTricia Townsend  
Dr. Richard Tyler-Walker  
Dr. Millicent Valek

Dr. Sue Wasiolek  
Dr. Jessica L. White  
Dr. Dennis Wiese  
Dr. Cathy Williams  
Dr. Sandra Williams  
Dr. Stelfanie Williams  
Dr. Mary Ann Wolf  
Dr. Carrie Zelna

SCIENCE, TECHNOLOGY,  
ENGINEERING, AND MATHEMATICS  
EDUCATION FACULTY

**Dr. Aaron C. Clark,**  
**Department Head**

Dr. Robin K. Anderson  
Dr. Margaret R. Blanchard  
Dr. K.C. Busch  
Dr. Sunghwan Byun  
Dr. Cesar Delgado  
Dr. Cameron DeLeon Denson  
Dr. Cyndi Edgington  
Ms. Mariam Elias  
Dr. Ruby Ellis  
Dr. Marissa M. Franzen  
Dr. Karen F. Hollebrands  
Dr. Carla C. Johnson  
Dr. M. Gail Jones  
Dr. Tamecia R. Jones  
Dr. Erin Krupa  
Dr. Hollylynne S. Lee  
Dr. Brian Matthews  
Dr. Steven L. Miller  
Mr. John Parks Newby  
Dr. Soonhye Park  
Dr. Matt Reynolds  
Mr. Erik Schettig  
Dr. Eric Wiebe

**EMERITI FACULTY**

Dr. Theodore J. Branoff  
Dr. Glenda S. Carter  
Dr. Jere Confrey  
Dr. Johnny L. Crow  
Dr. William DeLuca  
Dr. William J. Haynie  
Dr. John Ronald Kolb  
Dr. John E. Penick  
Dr. Alice Y. Scales  
Dr. William J. VanDerWall  
Dr. Larry W. Watson  
Dr. Robert E. Wenig  
Dr. John H. Wheatley

**AFFILIATED FACULTY**

Dr. Tameshia S. Ballard  
Dr. Jo-Ann Cohen

TEACHER EDUCATION AND  
LEARNING SCIENCES FACULTY

**Dr. Kevin M. Oliver,**  
**Department Head**

Dr. Chandra Alston  
Ms. April Y. Bartley  
Dr. Candy M. Beal  
Dr. Drinda Bengé  
Dr. Vandna Bindra  
Dr. Christy M. Byrd  
Dr. Sarah E. Cannon

Dr. Sarah J. Carrier  
Dr. Maria R. Coady  
Dr. Cathy L. Crossland  
Dr. Dennis S. Davis  
Dr. Deniz Eseryel  
Dr. Michelle M. Falter  
Dr. Valerie N. Faulkner  
Dr. DeLeon L. Gray  
Dr. Jill F. Grifenhagen  
Dr. Kristin F. Hoffmann  
Dr. Jessica H. Hunt  
Dr. Micha J. Jeffries  
Dr. Shiyan Jiang  
Dr. Jill S. Jones  
Ms. Betsy Knight  
Dr. Joanna G. Koch  
Ms. Kari Kuebel  
Dr. Crystal C. Lee  
Dr. John K. Lee  
Dr. Jordan Lukins  
Dr. Meghan M. Manfra  
Dr. Patricia L. Marshall  
Dr. Samantha Marshall  
Dr. Florence Martin  
Dr. Paula J. McAvoy  
Dr. Julia O. McKeown  
Dr. James Minogue  
Dr. John L. Nietfeld  
Dr. Amato Nocera  
Dr. Jamie N. Pearson  
Dr. Jackie Relyea  
Dr. Terrell Robinson  
Ms. Melanie W. Smith  
Dr. Paola Sztajn  
Dr. Margareta M. Thomson  
Mr. Keith T. Walkowiak  
Dr. Temple A. Walkowiak  
Dr. Angela M. Wiseman  
Dr. Carl A. Young

**EMERITI FACULTY**

Dr. Douglas A. Cullinan  
Dr. Barbara J. Fox  
Dr. Susan S. Osborne  
Dr. Barbara M. Parramore  
Dr. Carol A. Pope  
Dr. Ruie J. Pritchard  
Dr. Edward J. Sabornie  
Dr. Hiller A. Spires  
Dr. Samuel S. Snyder  
Dr. Lois Thies-Sprinthal  
Dr. Ellen S. Vasu

**AFFILIATED FACULTY**

Dr. Leah Bug  
Dr. Jody L. Clevén  
Dr. Marcia S. Davis  
Dr. Jessica DeCuir-Gunby  
Dr. Lisa G. Hervey  
Dr. Ondrej Pesout  
Dr. Erin T. Horne  
Dr. Shaun B. Kellogg  
Dr. Glennda McKeithan  
Dr. Whitney N. McCoy  
Dr. Melissa Rasberry  
Dr. James R. Smith, Jr.

**NC STATE**  
College of Education



**Mission**

The College of Education is a voice of  
innovation for learning across the lifespan.

We prepare professionals  
who educate and lead.

Our inquiry and practice reflect integrity,  
a commitment to social justice, and  
the value of diversity in a global community.

**Vision**

The College of Education will lead the way in North Carolina  
in increasing opportunities for success in education and  
in reducing achievement gaps.

**College of Education Deans' Cabinet**

Paola Sztajn, Dean

Karen Hollebrands, Associate Dean for Research and Innovation

Erin Horne, Assistant Dean for Assessment and Professional Education

Hector Junco, Assistant Dean for Operations

John K. Lee, Associate Dean for Faculty and Academic Affairs

Anona Smith Williams, Associate Dean for Student Success

**NC STATE UNIVERSITY**  
College of Education



[ced.ncsu.edu](http://ced.ncsu.edu)

