

NC STATE College of Education

COMMENCEMENT CEREMONY



December 16, 2022

Educational Leadership, Policy, and Human Development
Science, Technology, Engineering, and Mathematics Education
Teacher Education and Learning Sciences



Order of Exercises

Processional

Welcome

Dr. Paola Sztajn
Dean

Introduction of Student Speaker

Dr. Anona Smith Williams
Associate Dean

Charge to the Students

Monica Meza
Master of Education
Educational Leadership, Policy,
and Human Development

Presentation of Doctoral Degrees

Dr. Karen Hollebrands
Associate Dean

Educational Leadership, Policy, and Human Development

Dr. Marc A. Grimmett
Associate Department Head

Science, Technology, Engineering, and Mathematics Education

Dr. Aaron C. Clark
Department Head

Teacher Education and Learning Sciences

Dr. Kevin M. Oliver
Department Head

Presentation of Master's Degrees

Dr. John K. Lee
Associate Dean

Educational Leadership, Policy, and Human Development

Dr. Marc A. Grimmett

Science, Technology, Engineering, and Mathematics Education

Dr. Aaron C. Clark

Teacher Education and Learning Sciences

Dr. Kevin M. Oliver

Presentation of Undergraduate Degrees

Dr. John K. Lee

Science, Technology, Engineering, and Mathematics Education

Dr. Aaron C. Clark

Teacher Education and Learning Sciences

Dr. Kevin M. Oliver

Closing Remarks

Dr. Paola Sztajn

Reception to follow on Stafford Commons

EDUCATIONAL LEADERSHIP, POLICY,
AND HUMAN DEVELOPMENT

DOCTOR OF EDUCATION DEGREES

Harry George Barto¹

Adult and Community College Education

Hiring and Retaining High Quality Teachers in a Small, Private Preparatory School. (Under the direction of Professor James Bartlett.)

Maryann South Aucompaugh

Community College Leadership

Faculty Advisor Viewpoints of Advising Roles—A Q Methodology Study. (Under the direction of Professors Diane Chapman and Carrol Warren.)

Catelin Margaret Jones May

Community College Leadership

MilSpouseEd: Ethnographic Representation of Military Spouse Access to Higher Education. (Under the direction of Professor Michelle Bartlett.)

DOCTOR OF PHILOSOPHY DEGREES

Brittany Renee' Barber

Educational Leadership, Policy, and Human Development, Counseling & Counselor Education

A Phenomenological Approach Exploring the Experience and Persistence of Millennial Black Women Faculty in Counselor Education. (Under the direction of Professor Su-Man Ting.)

Nicholas M. Hudak

Educational Leadership, Policy, and Human Development, Adult and Lifelong Education

Policy Predictors of Physician Assistant Student Mistreatment Reporting. (Under the direction of Professor Duane Akroyd.)

Elizabeth Ashlyn Locklear

Educational Leadership, Policy, and Human Development, Adult and Lifelong Education

Educating for Uncertainty: A Qualitative Study on Preparing Future-Ready Physicians through Master Adaptive Learning. (Under the direction of Professor Jayne Fleener.)

Rachel Harris Monteverdi

Educational Leadership, Policy, and Human Development, Adult and Lifelong Education

Leadership and Learning Through the Lens of The Leadership Challenge Certified Masters. (Under the direction of Professors Michelle Bartlett and Jacklyn Bruce.)

Laura Anne Ivey¹

Educational Leadership, Policy, and Human Development, Educational Evaluation and Policy Analysis

Academics in Kindergarten: Helping Kids Catch-up or Fall Behind? (Under the direction of Professors Timothy Drake and Michael Little.)

Holley Brookes Nichols¹

Educational Leadership, Policy, and Human Development, Higher Education

Opportunity Grounded in Geography: Rural Transfer Students Majoring in Science, Technology, Engineering, and Math. (Under the direction of Professor Paul Umbach.)

Nicole Rocchio Guistwite

Educational Research and Policy Analysis, Higher Education Administration

Heterogeneous Effects of High School College Counselors on College Access and Choice. (Under the direction of Professor Stephen Porter.)

Ana Mari McClanahan¹

Educational Research and Policy Analysis, Workforce & Human Resource Education

Multigenerational Classrooms: Understanding Community College Faculty Experiences. (Under the direction of Professor Duane Akroyd.)

SCIENCE, TECHNOLOGY, ENGINEERING, AND MATHEMATICS EDUCATION

DOCTOR OF PHILOSOPHY

Emily Calhoun Elrod¹

Learning and Teaching in STEM, Mathematics and Statistics Education

Education Teaching Mathematics for Conceptual Understanding: An Examination of Elementary and Secondary Teacher Candidates. (Under the direction of Professors Cynthia Edgington and Temple Walkowiak.)

Joshua Parker Mannix

Learning and Teaching in STEM, Mathematics and Statistics Education

Exploring Characteristics and Experiences of Secondary Mathematics Teachers with Math Anxiety. (Under the direction of Professor Erin Krupa.)

Courtney Taylor NeSmith¹

Learning and Teaching in STEM, Mathematics and Statistics Education

Instructors' Decisions About Resources Utilized for Teaching Mathematics Online. (Under the direction of Professor Erin Krupa.)

Pamela Marler Huff

Learning and Teaching in STEM, Science Education

Teaching Science in Charter Schools: Facilities, Equipment, Teacher Perceptions, and Impact of the COVID-19 Pandemic. (Under the direction of Professor Gail Jones.)

K. Ren Rende¹

Learning and Teaching in STEM, Science Education

We Can Update Our Own Stories: Trans*-Informed Principles for LGBTQ+ Inclusive Science Teaching. (Under the direction of Professor Gail Jones.)

Gary William Wright, III¹

Learning and Teaching in STEM, Science Education

Queering Science Teacher Education: Exploring Changes in Pre-Service Science Teachers' Attitudes and Beliefs about Gender and Sexual Diversity-Inclusive Science Teaching. (Under the direction of Professor Cesar Delgado.)

¹Summer graduate

DOCTOR OF PHILOSOPHY

Kimberly Sheryl Jones Kemp

Curriculum and Instruction

Designing for Younger Readers: Adolescents Expand Their Literacy Skills and Identities by Writing Tutoring Modules for Elementary Students. (Under the direction of Professor Dennis Davis.)

Rebeca Aurora Calderon Lima¹

Teacher Education and Learning Sciences, Educational Psychology

The Impact of Metacognition and Design Thinking on Creative Problem-Solving in a Teacher Preparation Course. (Under the direction of Professor John Nietfeld.)

Marina Wagemaker¹

Teacher Education and Learning Sciences, Educational Psychology

Metacognition of Academic Speech for International Multilingual Graduate Students. (Under the direction of Professor Christy Byrd.)

Laura Marie Romeo¹

Teacher Education and Learning Sciences, Elementary Education in Math and Science

The Preservice Teacher Approach: An Exploratory Case Study of Universal Design for Learning (UDL) and Assistive Technology in Elementary Science Instruction. (Under the direction of Professor James Minogue.)

Waylon Keith Lindsay¹

Teacher Education and Learning Sciences, Learning Design and Technology

Investigating the Creation of Online Courses: A Multi-case Study of Development Team Discussions. (Under the direction of Professor Julia McKeown.)

Angelica Lynn Morgan

Teacher Education and Learning Sciences, Learning Design and Technology

Family Engagement Within an Inclusive Technology Ecosystem. (Under the direction of Professor Kevin Oliver.)

Laura Emily Jacobs¹

Teacher Education and Learning Sciences, Literacy and English Language Arts Education

Scripting the Narrative: A Critical Content Analysis of EL Education's Middle School English Language Arts Curriculum. (Under the direction of Professor Carl Young.)

Nada Wafa¹

Teacher Education and Learning Sciences, Social Studies Education

Infusing Global Perspectives through Inquiry in Social Studies Classrooms Around the World: A Narrative Inquiry. (Under the direction of Professor Meghan Manfra.)

MASTER OF EDUCATION

Adult and Community College Education

Andrew Beveridge
Megan Nicole DeJohn
Autumn Leigh Evans
David Little Fichuo
Russell Evan Gardner
Jeremy Paul Sites
Chandler Antony Zavala

Clinical Mental Health Counseling

LaDrea Ingram

College Counseling and Student Development

Erica Michelle Jimenez
Sabrina Olivia Spencer

Higher Education Administration

Monica Meza¹
Katherine Jane Sapko
Kevin Cooper Singer

School Counseling

Rachel Thompson Bustle
Thomas O'Hanlon Evanoff
Tashaunna M. Hughes
Cassie Ashton Kelley
Erich MacLaren
Anna Rose Mooring
Dana Rae Needham
Abegale Margaret Parker
Julianne June Salvadore
Julia Nicole Thramann
Mallory Hodge Whitley

Training and Development

Madeline Alden
Grace Elizabeth Barrett
Matthew Paul Bedard
Victoria Arzu Milligan¹
Michelle Bridgers Norwood
Thanaree Alyssa Pickens
Sherie Lynn Quillen
Crystal Rose Rhynes
John Alexander Russell
Jennifer Ann Scoggins
Tara Lynn Willis

MASTER OF SCIENCE

Higher Education

Benjamin James Dictus

SCIENCE, TECHNOLOGY, ENGINEERING,
AND MATHEMATICS EDUCATION

MASTER OF EDUCATION

Engineering & Technology Education

David Morgan Jenkins

Math and Statistics Education

Jacobie Bond

Jacob Craige Cole¹

Muhammer Kurt¹

Carlton Dane Peterson

Jeffrey Richard Serra

Science Education

Meredith Adele Fish

Christiana Jameson

Ana-Maria Topliceanu¹

Technology Education

Thomas William Karches

MASTER OF ARTS IN TEACHING

Mathematics Education

Maggie Knostman[^]

Kaili Marie Saffran¹

Science Education

Karen Black

Margaret Joe Bumgarner

Michaela Kathleen Connors[^]

Collin Lee Ferebee

John David Kanipe

Michelle Lynne Neish

Jacquelyn Alicia Ringrose

Emily Cowell Wilkinson [^]

TEACHER EDUCATION
AND LEARNING SCIENCES

MASTER OF EDUCATION

Curriculum and Instruction – Curriculum and Developmental Supervision

Jean Grace Wilson-Stayton¹

Curriculum and Instruction – New Literacies and Global Learning – Middle Grades Education

Emily Grace Braren¹

Curriculum and Instruction – New Literacies and Global Learning – Social Studies Education

Jonathan Grebenkemper McGovern¹

Jessie Gwen Van Cura¹

Learning, Design and Technology

Carolyn Hannah Alphin

Joelle Lee Chase

Tracy Demarest

James Martin Hardaway

Elizabeth Ann Heisel

Cynthia Ann MacDonald

Irina Vlada Welsh¹

Special Education

Rebecca Marie Prater

MASTER OF ARTS IN TEACHING

Elementary Education

Mary Katherine Toney Askins

Shatila J. Banks

Jennifer Biamonte

Shelby Ann Brown

Jenna Chandler

Emily Clancey

Lindsay Jordan Crassweller

Whitni Denise Duffey

Susan Goodroe Forester

Skyler Morgan Guin

Hannah Elisabeth Hagans

Alaina Kaupa

Abby Ross Lee

Nicollette Marlene Martinez

Kristina Moss^{*}

Jean McChesney Osborne

Danielle Justina Pope

Teresa J. Price

Sarah Marie Robinson

Ruth Anne Rogers

Anindita Roy

Lucynda Noelle Scheffer

Gabriella Walata

¹Summer graduate [^]Teaching Fellows Program

English Education

Jordan Richard Hansgen¹
Chloe Christian Ray Mateus
Mitra Norowzi¹

English as a Second Language

Spencer Main
Constance Danielle McDuffie
Elizabeth Ann Stamp

Middle Grades Language Arts Education

Precious Jewel Sidbury¹

Middle Grades Social Studies Education

Jaleesa Jasmine Ames
Beau Borek
Holly Knapp Hogarth¹

Social Studies Education

Rock William Gremillion, Jr.
Thomas Guy
Jasmine Moreno¹
Sarah Elizabeth Patton¹
Parker Jamison Reinhardt
Joseph James Williams¹
David Peter Witkowski

Special Education

Caitlyn Marie Harmsen
Meghan Lea

SCIENCE, TECHNOLOGY, ENGINEERING,
AND MATHEMATICS

BACHELOR OF SCIENCE

Mathematics Education

John Benton¹

Amber Faith Long^{^#}
Derrick Joseph McCann
Claudia Pauline Sutton¹

Science Education

Zainab Bhatti[^]
Abigail Mary Haydon^{****^}

Technology, Engineering, and Design Education

Harper Douglass Atkins
Trevor William Dezso
Trevor Mason Dill^{*}
Thomas Xavier Ellis
Jacob Robert Griffith
Michael Morsey

TEACHER EDUCATION
AND LEARNING SCIENCES

BACHELOR OF SCIENCE

Applied Education Studies

Kenneth Morris Askew
Nadia Jordan Boron^{***}
Sarah Broughton
Matthew Ryan Decker¹
Marissa Danielle Hunter^{**}
Lauren Elizabeth Joyner
Tianna A. Perry^{***}
Maha Syed
Payton Tanner Wilson

Elementary Education

John A. Church^{**}

Middle Grades Education

Hunter Alexander Grantham^{1**}

Directions to reception on Stafford Commons, the green space behind the Talley Student Union.

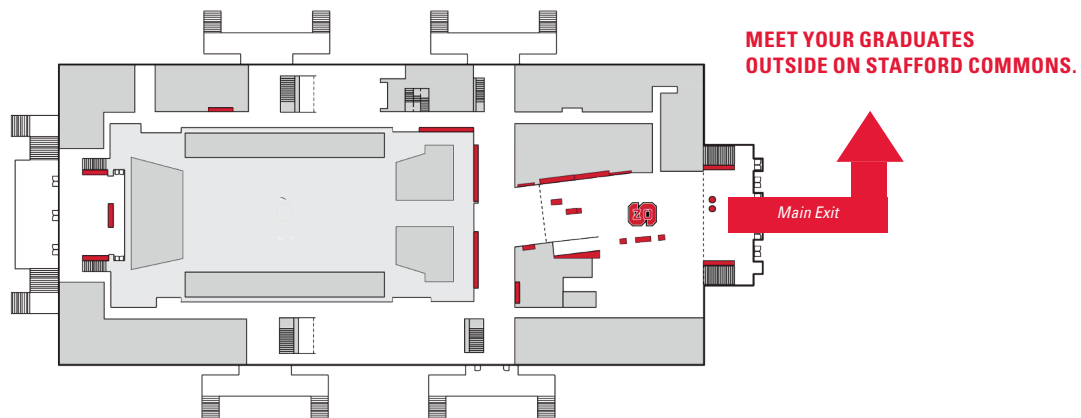

EDUCATIONAL LEADERSHIP, POLICY,
AND HUMAN DEVELOPMENT
FACULTY

**Dr. John K. Lee, Interim Department
Head**

**Dr. Marc A. Grimmert, Associate
Department Head**

Dr. Duane Akroyd
Dr. Jennifer B. Ayscue
Dr. Stanley B. Baker
Dr. Susan J. Barcinas
Dr. Krispin W. Barr
Dr. James E. Bartlett II
Dr. Michelle E. Bartlett
Dr. Lisa R. Bass
Dr. Cristina Braga
Dr. Diane D. Chapman
Dr. Nicole Childs
Dr. Mary Ann Danowitz
Dr. Timothy A. Drake
Dr. Adria E. Dunbar
Dr. Anna J. Egalite
Dr. Kenneth L. Ender
Dr. M. Jayne Fleener
Dr. Bonnie C. Fusarelli
Dr. Lance D. Fusarelli
Dr. Joy Gaston Gayles
Dr. Peter A. Hessling
Dr. Chad D. Hoggan
Dr. Audrey J. Jaeger
Dr. Henry L. Johnson
Dr. Pooneh Lari
Dr. Michael Little
Dr. Rolanda Mitchell
Dr. Sylvia Nassar
Dr. Brean'a Parker
Dr. Lam Pham
Dr. Jose' A. Picart
Dr. Stephen R. Porter
Dr. Francine P. Riddick
Dr. Mary E. Ritting
Dr. Alyssa N. Rockenbach
Dr. Angela C. Smith
Dr. Robert G. Templin
Dr. Terri Tillford
Dr. Siu-Man Raymond Ting
Dr. Paul D. Umbach
Dr. Elizabeth Vincent
Dr. Michael E. Ward
Dr. Carrol L. Warren
Dr. Lesley G. Wirt
Dr. Tamara V. Young

DEAN EMERITA

Dr. Kathryn M. Moore

EMERITI FACULTY

Dr. George A. Baker III
Dr. Paul F. Bitting
Dr. Edwin Gerler
Dr. J. Conrad Glass Jr.
Dr. Lawrence K. Jones
Dr. Carol E. Kasworm
Dr. Elizabeth MacPhail-Wilcox
Dr. Julie G. McVay
Dr. Robert C. Serow
Dr. Norman A. Sprinthall
Dr. Raymond G. Taylor Jr.

AFFILIATED FACULTY

Dr. Amanda H. Allen

Dr. Frim Ampaw
Dr. Patricia Ashley
Dr. Donna W. Bailey
Dr. Clinton Bolton
Dr. Bryan Brander
Dr. Crystal Brown
Dr. William Carver
Dr. Lisa Chapman
Dr. Jemilia S. Davis
Dr. Karrie G. Dixon
Dr. Pamela Eddy
Dr. James Ellerbe
Dr. Pamela Earp
Dr. Carol Figuers
Dr. Jean Fleming
Dr. Cynthia W. Geary
Dr. Paula Gentius
Dr. Bethany Glueck
Dr. Gary Green
Dr. Gayle Greene
Dr. Karen Haley
Dr. William C. Harrison
Dr. Garrett Hinshaw
Dr. Pamela B. Howze
Dr. William Ingram
Dr. Anthony Jackson
Dr. Cynthia W. Johnson
Dr. David Johnson
Dr. Linda Krute
Dr. Kathy D. Lohr
Dr. Deborah C. Luckadoo
Dr. Tim Luckadoo
Dr. Bruce Mallette
Dr. Bryan Martin
Dr. Audrey K. Martin-McCoy
Dr. Mildred Maxwell
Dr. Darryl D. McGraw
Dr. Dale McInnis
Dr. Larry Moneta
Dr. Sharon Morrissey
Dr. Pascal Mubenga
Dr. Martin Nadelman
Dr. Diana Oblinger
Dr. Tony O'Driscoll
Dr. Barry Olson
Dr. Amy B. Orders
Dr. Monica Osburn
Dr. Andy Overstreet
Dr. Colleen G. Paeplow
Dr. Randy Parker
Dr. Rodney Peterson
Dr. Donna T. Petherbridge
Dr. Rachel Porter
Dr. Eddie Price
Dr. R. Scott Ralls
Dr. Carol D. Raubenheimer
Dr. Donald L. Reichard
Dr. Lawrence Rouse
Dr. Ryan D. Rucker
Dr. Doneka Scott
Dr. Stephen Scott
Dr. Pamela Senegal
Dr. Kim Sepich
Dr. Trip Stallings
Dr. Jennifer Stanigar
Dr. Jason Taylor
Dr. Courtney H. Thornton
Dr. LaTricia Townsend
Dr. Richard Tyler-Walker
Dr. Millicent Valek
Dr. Sue Wasiolek

Dr. Jessica L. White
Dr. Dennis Wiese
Dr. Cathy Williams
Dr. Sandra Williams
Dr. Stelfanie Williams
Dr. Mary Ann Wolf
Dr. Carrie Zelna

SCIENCE, TECHNOLOGY,
ENGINEERING, AND MATHEMATICS
EDUCATION FACULTY

Dr. Aaron C. Clark, Department Head

Dr. Robin K. Anderson
Dr. Margaret R. Blanchard
Dr. K.C. Busch
Dr. Sunghwan Byun
Dr. Cesar Delgado
Dr. Cameron DeLeon Denson
Dr. Cyndi Edgington
Dr. Ruby Ellis
Dr. Marissa M. Franzen
Dr. Karen F. Hollebrands
Dr. Carla C. Johnson
Dr. M. Gail Jones
Dr. Tamecia R. Jones
Dr. Erin Krupa
Dr. Hollylynn S. Lee
Dr. Brian Matthews
Dr. Steven L. Miller
Mr. John Parks Newby
Dr. Soonhye Park
Dr. Matt Reynolds
Dr. Erik Schettig
Dr. Eric Wiebe

EMERITI FACULTY

Dr. Norman Dean Anderson
Dr. Theodore J. Branoff
Dr. Glenda S. Carter
Dr. Jere Confrey
Dr. William DeLuca
Dr. Johnny L. Crow
Dr. William J. Haynie
Dr. John Ronald Kolb
Dr. John E. Penick
Dr. Alice Y. Scales
Dr. Harriet Stubbs
Dr. William J. VanDerWall
Dr. Larry W. Watson
Dr. Robert E. Wenig
Dr. John H. Wheatley

AFFILIATED FACULTY

Dr. Tameshia S. Ballard
Dr. Jo-Ann Cohen

TEACHER EDUCATION AND
LEARNING SCIENCES FACULTY

Dr. Kevin M. Oliver, Department Head

Dr. Chandra Alston
Ms. April Y. Bartley
Dr. Candy M. Beal
Dr. Drinda Bengé
Dr. Vandna Bindra
Dr. Christy M. Byrd
Dr. Sarah E. Cannon
Dr. Sarah J. Carrier
Dr. Maria R. Coady

Dr. Cathy L. Crossland
Dr. Dennis S. Davis
Dr. Deniz Eseryel
Dr. Michelle M. Falter
Dr. Valerie N. Faulkner
Dr. DeLeon L. Gray
Dr. Jill F. Grifenhagen
Dr. Kristin F. Hoffmann
Dr. Jessica H. Hunt
Dr. Micha J. Jeffries
Dr. Shiyang Jiang
Dr. Jill S. Jones
Ms. Betsy Knight
Dr. Joanna G. Koch
Ms. Kari Kuebel
Dr. Crystal C. Lee
Dr. John K. Lee
Dr. Jordan Lukins
Dr. Meghan M. Manfra
Dr. Patricia L. Marshall
Dr. Samantha Marshall
Dr. Florence Martin
Dr. Paula J. McAvoy
Dr. Julia O. McKeown
Dr. James Minogue
Dr. John L. Nietfeld
Dr. Amato Nocera
Dr. Jamie N. Pearson
Dr. Jackie Relyea
Dr. Terrell Robinson
Ms. Melanie W. Smith
Dr. Paola Sztajn
Dr. Margareta M. Thomson
Mr. Keith T. Walkowiak
Dr. Temple A. Walkowiak
Dr. Angela M. Wiseman
Dr. Carl A. Young

EMERITI FACULTY

Dr. John F. Arnold
Dr. Douglas A. Cullinan
Dr. Barbara J. Fox
Dr. Susan S. Osborne
Dr. Barbara M. Parramore
Dr. Carol A. Pope
Dr. Ruie J. Pritchard
Dr. Edward J. Sabornie
Dr. Samuel S. Snyder
Dr. Hiller A. Spires
Dr. Lois Thies-Sprinthall
Dr. Ellen S. Vasu

AFFILIATED FACULTY

Dr. Leah Bug
Dr. Jody L. Cleven
Dr. Marcia S. Davis
Dr. Jessica DeCuir-Gunby
Dr. Lisa G. Hervey
Dr. Erin T. Horne
Dr. Shaun B. Kellogg
Dr. Glennnda McKeithan
Dr. Whitney N. McCoy
Dr. James R. Smith Jr.
Dr. Jonee Wilson

Mission

The College of Education is a voice of innovation for learning across the lifespan.
We prepare professionals who educate and lead.
Our inquiry and practice reflect integrity, a commitment to social justice, and the value of diversity in a global community.

Vision

The College of Education will lead the way in North Carolina in increasing opportunities for success in education and in reducing achievement gaps.

College of Education Deans' Cabinet

Paola Sztajn, Dean
Karen Hollebrands, Associate Dean for Research and Innovation
Erin Horne, Assistant Dean for Assessment and Professional Education
Hollylynn Lee, Interim Associate Dean, The Friday Institute
John K. Lee, Associate Dean for Faculty and Academic Affairs
Anona Smith Williams, Associate Dean for Student Success

NC STATE UNIVERSITY
College of Education



ced.ncsu.edu

